



ONE JACKSON SQUARE DOGHOUSE

Design: Set on an urban terrace, in a backyard, or even in a living room, the One Jackson Square Doghouse offers a fresh take on canine quarters. Designed for the city dog, the country dog, and the spoiled dog, the organic form cradles the curled up canine in slumber, while the grassy—eco-friendly—rooftop fulfills every dog’s dream of a perch with a panoramic view.

Features: A freestanding “floor” provides a comfortable buffer between dog and ground and offers easy maintenance. The geometry of the shelter is designed to control airflow, filtering cool summer breezes into the interior and, by rotating the structure, keeping winter winds at bay. Cross-ventilation is achieved through strategic placement of horizontal apertures. A drainage system is an integral part of the roof.

Materials: 250 unique pieces of laminated Baltic birch plywood milled using computer-numerical-control fabrication technology.

Dimensions: TK x TK x TK

Weight: TK pounds

Architects: William Pedersen and Trent Tesch, KPF
Fabrication Consultant: Situ Studio
Sponsors: Hines/One Jackson Square, KPF, and Situ Studio

CONCEPT



PROTOTYPE



NESTING DOG

GEOMETRY



Plan

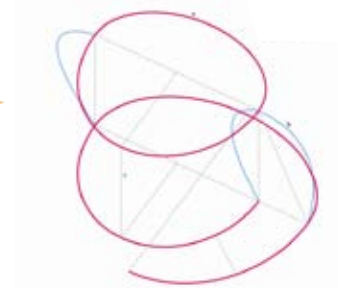

Plan/Section Geometry

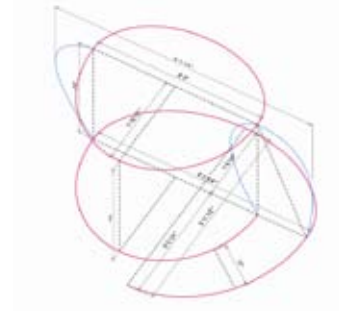

Basic Dimensions



Surface Generation=Section Profiles + Plan Profiles



Cutting Profile



Final Surface Geometry

FABRICATION

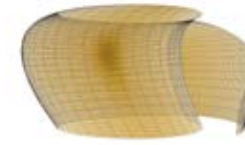

3d Surface



Horizontal Plan Section Cuts

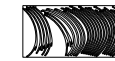
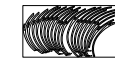
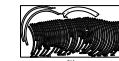
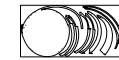
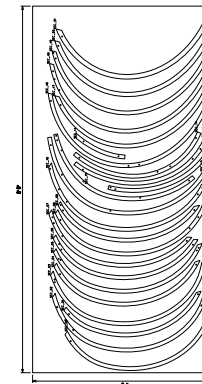
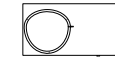

"Nested" Plans



CNC routing

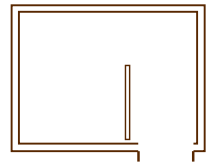

Basic Kennel Plan

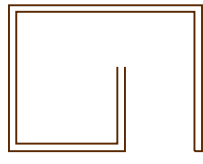

Plan Essence

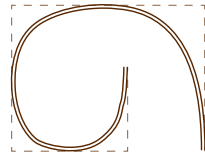

Plan Abstraction